

WIRELESS KEYLESS ENTRY – MODEL SERIES 66 AND 740

FEATURES OF THE KEYPAD TRANSMITTER

Personalized Code: Up to 10,000 possible combinations. Code can easily be changed if desired.

Operation: Opener activates when 4-code digits and ENTER button are pressed.

The Keypad Transmitter will open and close the door even if the Door Control Lock Switch feature is ON.

If wrong numbers are accidentally pressed, correction can be made immediately. The ENTER key will transmit only the last four digits.

The keypad will blink for 15 seconds after the code is transmitted. During that time, you can STOP or REVERSE door travel just by pressing the ENTER key.

The keypad transmitter can be used with garage door opener receivers having a yellow, grey, white or green "learn" button.

Setting the Code

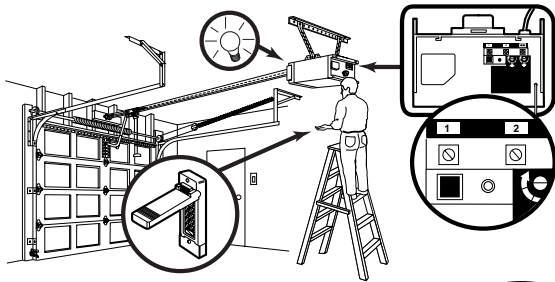

1. Press and release the "learn" button on motor unit. The learn indicator light will glow steadily for 30 seconds.
2. Within 30 seconds, enter a four digit personal identification number (PIN) of your choice on the keypad. Then press and hold the ENTER button.
3. Release the button when the motor unit lights blink. It has learned the code. If light bulbs are not installed, two clicks will be heard.

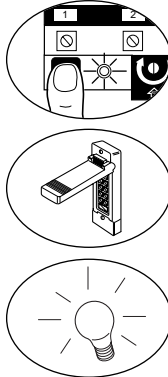

The Keyless Entry Battery

! WARNING

To prevent possible SERIOUS INJURY or DEATH:

- NEVER allow small children near batteries.
- If battery is swallowed, immediately notify doctor.

The 12 volt battery should produce power for at least one year. Replace when the keypad illumination becomes dim.

Dispose of old batteries properly.

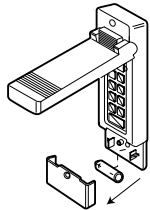

NOTICE: To comply with FCC and or Industry Canada rules, adjustment or modifications of this receiver and/or transmitter are prohibited, except for changing the code setting or replacing the battery. THERE ARE NO OTHER USER SERVICEABLE PARTS.

Tested to Comply with FCC Standards FOR HOME OR OFFICE USE. Operation is subject to the following two conditions: (1) this device may not cause harmful interference, and (2) this device must accept any interference received, including interference that may cause undesired operation.

! WARNING

To prevent possible SERIOUS INJURY or DEATH from a moving gate or garage door:

- ALWAYS keep remote controls out of reach of children. NEVER permit children to operate, or play with remote control transmitters.
- Activate gate or door ONLY when it can be seen clearly, is properly adjusted, and there are no obstructions to door travel.
- ALWAYS keep gate or garage door in sight until completely closed. NEVER permit anyone to cross path of moving gate or door.

Installation

Open the keypad cover and remove the battery compartment screw. Take out the battery. *Note the battery polarity as marked on compartment.*

Follow the installation instructions described below.

1. Center the keypad at eye level against the selected location on garage exterior as shown.

NOTE: For a one-piece door on a brick, stone or aluminum sided garage, use the optional location shown in the illustration to avoid injury as the door swings up and out.

2. Hold keypad firmly with cover half open so both the top and bottom mounting holes are visible. Use a punch to mark each hole. Drill two 1/8" pilot holes. Fasten securely with screws provided.
3. Insert the plug provided into the top hole to cover the fastening screw. Return the battery, being sure to observe polarity. Re-fasten compartment cover.

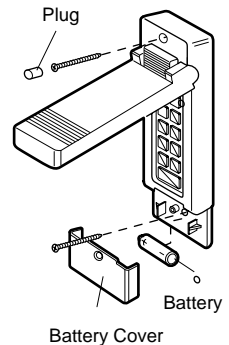
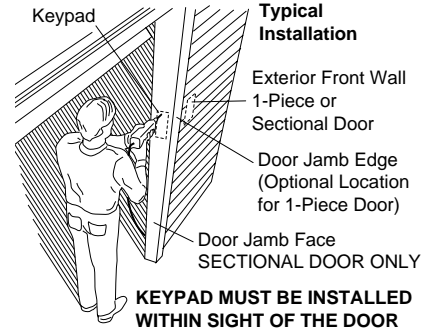

HOW TO ORDER REPAIR PARTS

DEK CANADA INC

1928 ST-REGIS BLVD.

DORVAL, QC

H9P 1H6

TEL: 514-685-5800

TOLL-FREE: 1-800-361-3198

FAX: 514-685-5804

www.dekcanada.com

**WHEN ORDERING REPAIR PARTS
PLEASE SUPPLY THE FOLLOWING INFORMATION:**

PART NUMBER	DESCRIPTION	MODEL NUMBER
--------------------	--------------------	---------------------